

# Technical data sheet

## Height adjustment unit for heavy-duty mounting lid

Item number: 7409686



The height adjustment units rated for increased load requirements permit the screed-flush height adjustment of the heavy-duty mounting lid and are to be ordered separately.  
The VPE consists of four height adjustment units.

CE

**St** Steel

**G** Electrogalvanized

### Master data

Item number	7409686
Type	DUG SL165
Description 1	Height-adjustment unit
Description 2	for heavy-duty mounting lid
Manufacturer	OBO
Dimension	165/200
Material	Steel
Surface	Electrogalvanized
Surface standard	EN ISO 19598 / EN ISO 4042
Smallest sales unit	1
Unit of quantity	Packaging unit
Weight	53.586 kg
Weight unit	kg/100 PUs
CO2 Footprint (GWP) Cradle-to-Gate	1,325 kg CO2e / 4 Piece

# Technical data sheet

## Height adjustment unit for heavy-duty mounting lid

Item number: 7409686



### Dimensions

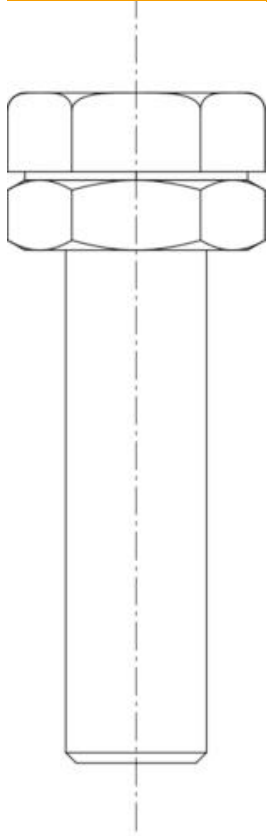

Length	158 mm
Width	19 mm
Height	19 mm
Dimension L	150 mm

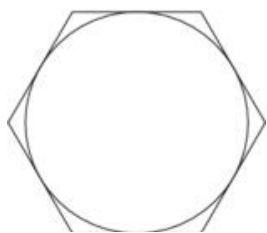

# Technical data sheet

## Height adjustment unit for heavy-duty mounting lid

Item number: 7409686



### Technical data

Type of accessory	Miscellaneous
Screed height, max.	200 mm
Screed height, min.	165 mm
Heavy-duty version	yes